



## Bourdon Tube Pressure Gauges

Field Repairable

All Stainless Steel Construction

Receiver Gauge • Process Industry Series Dry Case

Type 232.54RC

### Pressure Gauges

#### Application

Suitable for corrosive environments compatible with 316 stainless steel wetted parts, dry and liquid fillable case, where vibration and/or pressure pulsation occur in liquid or gaseous media which will not obstruct the pressure system. Ideal for pressure gauge / chemical seal combinations where recalibration is required.

#### Sizes

2½" & 4" (63 & 100mm)

#### Accuracy

2½": ±1.5% of span

4": ±1.0% of span (ASME B40.1 Grade 1A)

#### Ranges

Pressure from 3...15psi

or other equivalent units of pressure or vacuum

#### Working Range

2½" Steady: 3/4 of full scale value  
Fluctuating: 2/3 of full scale value  
Short time: full scale value

4" Steady: Full scale value  
Fluctuating: 0.9 x full scale value  
Short time: 1.3 x full scale value

#### Operating Temperature

Ambient: -40°F to 140°F (-40°C to 60°C) <sup>Note 1</sup>

Media: max. 212°F (+100°C)

#### Temperature Error

Additional error when temperature changes from reference temperature of 68°F (20°C) ±0.4% for every 18°F (10°C) rising or falling. Percentage of span.

### Standard Features

#### Connection

Material: 316 stainless steel

Lower mount (LM)

Center back mount (CBM) 2½"

Lower back mount (LBM) 4"

1/4" NPT or 1/2" NPT limited to wrench flat area

#### Bourdon Tube

Material: 316 stainless steel

#### Movement

300-series stainless steel

#### Dial

White aluminum with black lettering. 2½" with stop pin.

#### Pointer

Black aluminum, friction adjustable

#### Case

304 stainless steel with vent plug and polished stainless steel bayonet ring. EPDM o-ring between case and connection (4"). Welded case/socket connection (2½")



#### Weather Protection

Weather resistant (NEMA 3 / IP 54) - dry case

Weather tight (NEMA 4X / IP 65) - liquid-filled case

#### Standard Scale

0/100% linear

0/10 sq. rt.

#### Window Gasket

Buna-N

#### Window

Laminated safety glass

#### Case Filling

232.54 - none

233.54 - glycerine

#### ORDER OPTIONS (min. order may apply)

Custom dial layout

Front flange stainless steel polished

Rear flange stainless steel

u-clamp for panel mounting

316 SS threaded restrictor

Silicone or fluorolube case filling<sup>(NOTE 1)</sup> (Type 233.54)

Acrylic or flat glass window

Special connections limited to wrench flat area

DIN standards

Cleaned for oxygen service

Note 1 Temperature Ranges (Liquid filled gauges)

Glycerine: -4°F to 140°F (-20°C to 60°C)

Silicone: -40°F to 140°F (-40°C to 60°C)

**APM 232.54RC**  
(APM 02.14)

## Dimensions:

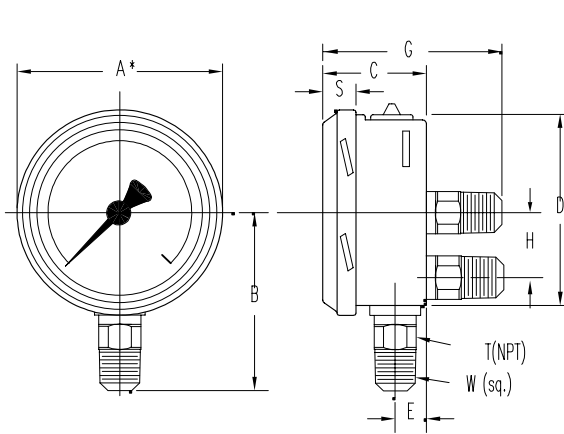

23X.54 LM/LBM/CBM

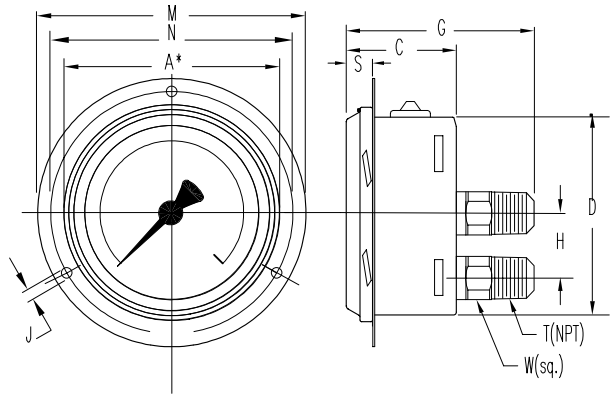

23X.54 LM/LBM/FF

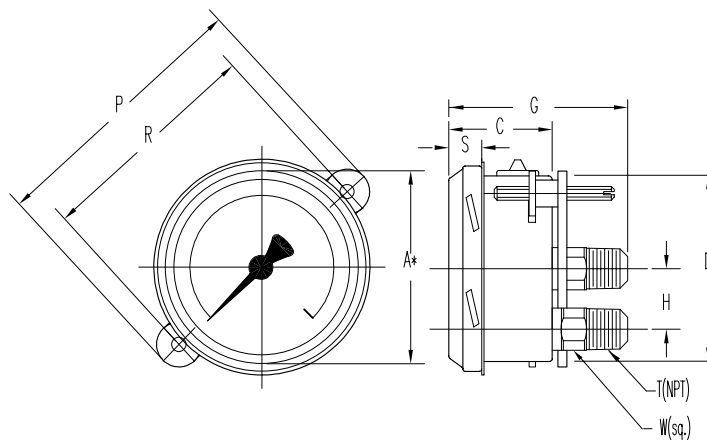

23X.54 LBM/CBM/UC

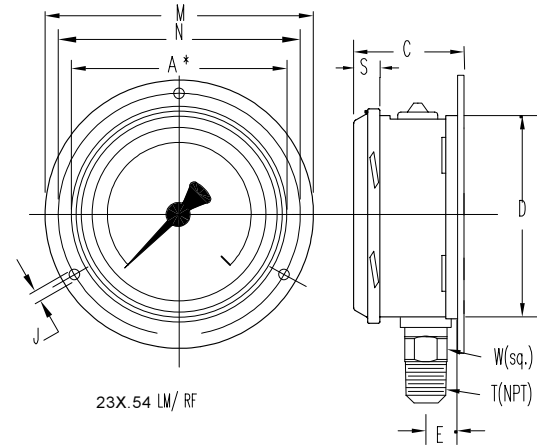

23X.54 LM/RF

A\* NOMINAL SIZE

TYPE	WEIGHT	KEY	A*	B	C	D	E	G	H	J	M	N	P	R	S	T	W
232.54 2.5"	0.36 lbs. + 0.08 lbs. if filled	mm	63	54	33.5	62	13	55.5	--	3.6	85	75	87	72	12	--	14
		in	2.5	2.13	1.32	2.44	0.51	2.19		0.14	3.35	2.95	3.43	2.83	0.47	1/4"	0.55
232.54 4"	1.10 lbs. + 0.66 lbs. if filled	mm	100	87	49.5	100	15.5	81	30	4.8	132	116	125	110	15	--	22
		in	4	3.43	1.95	3.94	0.61	3.19	1.18	0.19	5.2	4.57	4.92	4.33	0.59	1/2"	0.87

NOTE: For 4" gauges with 1/4" NPT connections, reduce B dimension by 5 mm (0.2 in.).

## THE MEASURE OF Total Performance™

### Ordering Information:

State computer part number (if available) / type number / size / range / connection size and location / options required.

Specifications given in this price list represent the state of engineering at the time of printing. Modifications may take place and the specified materials may change without prior notice.

05/01



**WIK A Instrument Corporation**

1000 Wiegand Boulevard

Lawrenceville, Georgia 30043-5868

Tel: 770-513-8200 Fax: 770-338-5118

http://www.wika.com e-mail: info@wika.com