

Bourdon Tube Pressure Gauge Type 111.10, ABS Plastic or Painted Steel Case Standard Series - Lower Mount

WIKA Datasheet APM 111.10

Applications

- Hydraulic and pneumatic systems
- Pumps, compressors, water systems, regulators
- Suitable for fluid medium which does not clog connection port or corrode copper alloy

Special features

- Copper alloy wetted parts
- ABS plastic or painted steel case
- Lower Mount (LM) process connection

Standard Features

Size (All sizes not stocked)

1½", 2", 2½" and 4" (40, 50, 63, and 100 mm)

Accuracy class

+ 3/2/3% of span (ASME B40.1 Grade B)

Bourdon Tube

Material: copper alloy

30"Hg (Vac) to 600 psi C-type

800psi to 6000 psi helical type

Movement

Copper Alloy

Dial

White plastic with stop pin (1½", 2", 2½")

White aluminum with stop pin (4")

Black or black and red lettering

Pointer

Black ABS plastic (1½", 2", 2½", 4" LM)

(2 and 2½" LM - black aluminum); non-adjustable

Case

Black ABS plastic

Bezel

None (1½", 2", 2½", & 4")



Bourdon Tube Pressure Gauge Type 111.10

Window

Snap-in acrylic (1½", 2", 2½", & 4")

Standard Scales

1½" psi, psi/kg/cm²

2" psi, psi/kpa, psi/kg/cm²

2½" psi, psi/kpa, psi/kg/cm²: 0/100% of linear, 0/10 sq. rt.

4" psi, psi/kpa, psi/kg/cm²: 0/100% of linear, 0/10 sq. rt.

Ranges (All ranges not stocked)

Vacuum/Compound to 30"Hg / 0/ 200psi

Pressure from 15psi to 6000psi

or other equivalent units of pressure or vacuum

Receiver scales 3...15psi

Working Range

Steady: ¾ of full scale value

Fluctuating: ⅔ of full scale value

Short time: full scale value

Operating Temperature

Ambient: -40°F to 140°F (-40°C to 60°C)

Media: max. 140°F (+60°C)

Temperature error

Additional error when temperature changes from reference temperature of 68°F (20°C) +0.4% for every 18°F (10°C) rising or falling. Percentage of span.

Optional Extras

- Accuracy + 2/1/2% of span (ASME B40.1 Grade A)
- Slip-fit or friction ring
- Case with blow-out plug
- Glass window
- Black painted steel case
- Stainless steel case
- Brass polished case and friction ring (2½" only)
- Special case colors
- Special connections (limited to wrench flat area)
- Cleaned for oxygen service
- Nickel plated connection
- Medical specification
- Rubber cover (2", 2½")
- Custom dial layout
- Other pressure scales available: Bar, kPa, MPa, kg/cm² and dual scales
- DIN standards
- Red set pointer on aluminum dial or on snap-on window
- External adjust red drag pointer (2½" only) (max. hand)

Note: ¹Press-fit brass restrictor standard for 111.10B, 1000psi to 6000psi

Dimensions

Standard versions

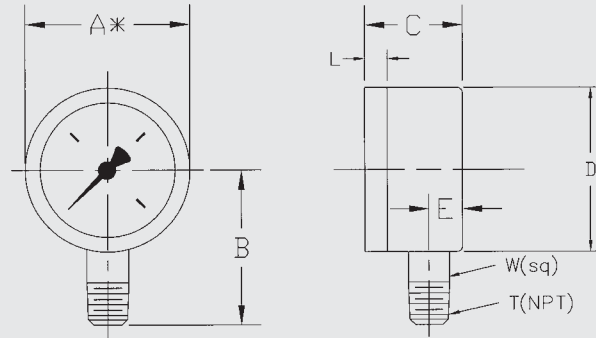

Type 111.10

Size		A	B ¹	C	D	E	L	T	W
1.5"	mm	40	36	23	41	8	-		12
	in	1.57	1.42	0.91	1.61	0.31	-	1/8"	0.47
2"	mm	50	45	27	49	10	-		14
	in	1.97	1.77	1.06	1.93	0.39	-	1/4"	0.55
2.5"	mm	63	53.5	28	61.5	10	-		14
	in	2.48	2.11	1.10	2.42	0.39	-	1/4"	0.55
4"	mm	100	83.5	30	99	11.5	-		14
	in	3.94	3.29	1.18	3.9	0.45	-	1/4"	0.55

Type 111.10B (brass case version)

Size		A	B ¹	C	D	E	L	T	W
2.5"	mm	63	52	27	61.5	9.5	10		14
	in	2.48	2.05	1.06	2.42	0.37	0.39	1/4"	0.55

¹To reduce 1/4" connection to 1/8", subtract 0.08 in. (2 mm) from B dimension

Ordering information

Pressure gauge model / Nominal size / Scale range / Size of connection / Optional extras required
 Specifications and dimensions given in this leaflet represent the state of engineering at the time of printing.
 Modifications may take place and materials specified may be replaced by others without prior notice.



WIKI Instrument Corporation