

# TrueSeal™ Thermoplastic Push-In Fittings

The patented\* TrueSeal™ push-to-connect thermoplastic fittings are light weight, reusable, and connect to plastic tubing without the use of tools.

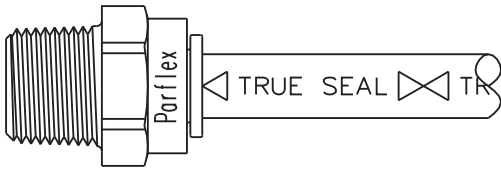

## Features

- All components in TrueSeal™ fittings are manufactured from FDA compliant materials and are NSF-51 listed for contact with food.
- Gray acetal TrueSeal™ fittings meet NSF-61 requirements for drinking water (potable water) system components.
- All-plastic body designs offer reduced weight, eliminate rust, corrosion, and system contamination in applications where metal components cannot be tolerated.
- Collets are offered in either a patented all-plastic design for use with flexible tubing or with a metal grip edge made from 300 series stainless steel for use on all tubing including copper. Connections made with metal gripper collets and tube stem adapters are not reusable.
- Extra deep tube seat in fitting body provides support to reduce side-load leakage.
- Elastomer o-ring seal provides positive compression on tubing O.D. in vacuum or pressure applications.
- Removable collet design permits o-ring replacement in the field. Collets are available in colors for easy color coding of systems.
- Tube stem adapters provide a wide range of tube-to-port jump size potential and allow elbows and tees to swivel for positive tube routing alignment.

## Applications

TrueSeal™ fittings find wide acceptance in water conditioning, filtration, and reverse osmosis industries and on water, soft drink, beer, wine, and condiment dispensing equipment. Industrial applications range from vacuum to low-pressure hydraulic and pneumatic systems on robotics, air logic, packaging/filling equipment, and conveyors. Ink and dye transfer, lubrication and cooling lines on presses, machine tools, ion implanting devices—all rely on TrueSeal™.

### Standard Materials

Material	Fitting Color	O-Ring
Acetal	Gray	Nitrile
Polypropylene	White	EPDM
Kynar®	Natural	Viton

Colored collets are also available in black, white, red, blue, green, yellow, and orange. Consult division.

KYNAR® is a registered trademark of Atochem North America, Inc.

\*U.S. Patent 5,584,513

**Note:** Provide adequate fail-safe mechanisms such as leakage detection sensors, automatic shut-off controls or other industry and code appropriate fail-safe devices in the design of your water-handling appliance to protect against personal injury and property damage. Plastic fittings containing an o-ring that are used in water applications should be replaced at least every five years or more frequently depending on the environment and severity of the application.

## How to Order

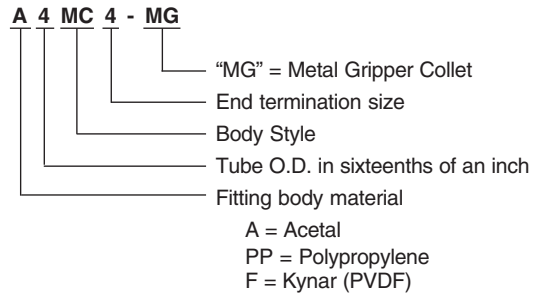

## Working Pressure

TrueSeal™ fittings are rated for the pressures listed below or at 1/4 (one-fourth) of the rated burst pressure of the tubing being used (whichever is less).

Fitting Size	Acetal	Polypropylene	Kynar®
5/32"	300		
1/4"	300	150	300
5/16"	300		
3/8"	300	150	300
1/2"	250		
Temp. Range	-20°F (-29°C) to +180°F (85°C)	0°F (-18°C) to +225°F (110°C)	0°F (-18°C) to +275°F (135°C)

These pressure ratings are based on tests conducted with Series NR tubing at 73°F. Actual working pressures may be lower at elevated temperatures. Consult division.

## Tubing

Parker TrueSeal™ fittings with all plastic collets can be used with the following tubing materials: polyethylene, polypropylene, nylon, vinyl, fluoropolymer, and polyurethane (3/8" and 1/2" polyurethane and all sizes of vinyl should use tube supports). TrueSeal™ fittings with metal gripper collets can be used with tubing listed above and soft copper tubing. For stainless steel or glass tubing or all other metal tubing, consult factory.

Tube Sizes	O.D. Tolerance	Insertion Depth
5/32"	±.005"	9/16"
1/4"	±.005"	11/16"
5/16"	±.005"	13/16"
3/8"	±.005"	3/4"
1/2"	±.005"	7/8"

## Assembly Instructions

1. Cut tubing square and clean. (Use a Parker plastic tube cutter, Part No. PTC.)
2. Mark from end of tube the length of insertion (see table above).
3. Push tube into the fitting until it bottoms out.
4. To remove, depress collet and pull tubing out.
5. Use Parflex TrueSealant™ (Part No. PTS) on threads.

# FC - Female Connector

## Tube-to-Pipe

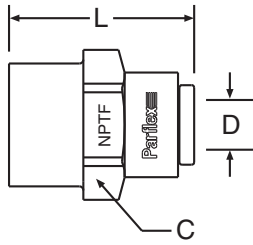

Gray Acetal Nitrile Seal	White Polypropylene EPDM Seal	Natural Kynar Viton Seal	Nom. Tube O.D.	NPTF Thread Size	C Hex	L Overall Length	D Thru Hole Min.
#	#	#					
A4FC2-MG	PP4FC2	F4FC2	1/4	1/8	11/16	1.20	.175
A4FC4-MG	PP4FC4	F4FC4	1/4	1/4	23/32	1.32	.175
A5FC4-MG			5/16	1/4	13/16	1.41	.188
A5FC6-MG			5/16	3/8	1	1.50	.188
A6FC4-MG	PP6FC4	F6FC4	3/8	1/4	13/16	1.41	.250
A6FC6-MG	PP6FC6	F6FC6	3/8	3/8	1	1.50	.250
A6FC8-MG			3/8	1/2	1-1/8	1.52	.250
A8FC6-MG			1/2	3/8	1-1/8	1.60	.375
A8FC8-MG			1/2	1/2	1-1/8	1.75	.375

For nonstandard plastic collet, remove -MG suffix.

# FF - 45° Female Flare

## Tube-to-Flare

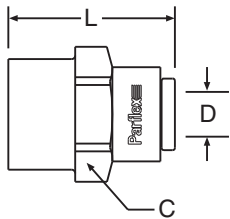

Gray Acetal Nitrile Seal	White Polypropylene EPDM Seal	Natural Kynar Viton Seal	Nom. Tube O.D.	UNF-2B Thread Size	C Hex	L Overall Length	D Thru Hole Min.
#	#	#					
A4FF4-MG	PP4FF4	F4FF4	1/4	7/16-20	23/32	1.32	.190
A6FF4-MG		F6FF4	3/8	7/16-20	13/16	1.41	.190
A6FF6-MG	PP6FF6	F6FF6	3/8	5/8-18	1	1.50	.250

For nonstandard plastic collet, remove -MG suffix.

All sizes in inches.

# MC - Male Connector

## Tube-to-Pipe

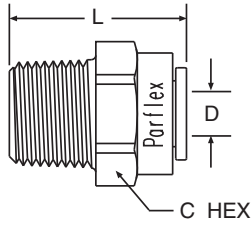

Gray Acetal Nitrile Seal	White Polypropylene EPDM Seal	Natural Kynar Viton Seal	Nom. Tube O.D.	NPTF Thread Size	C Hex	L Overall Length	D Thru Hole Min.
#	#	#					
A2.5MC2			5/32	1/8	0.55	0.80	.100
A2.5MC4			5/32	1/4	0.55	0.96	.100
A4MC2-MG	PP4MC2	F4MC2	1/4	1/8	11/16	1.28	.175
A4MC4-MG	PP4MC4	F4MC4	1/4	1/4	11/16	1.14	.175
A4MC6-MG	PP4MC6	F4MC6	1/4	3/8	11/16	1.18	.175
A5MC2-MG			5/16	1/8	13/16	1.46	.175
A5MC4-MG			5/16	1/4	13/16	1.41	.188
A5MC6-MG			5/16	3/8	13/16	1.27	.188
A6MC2-MG		F6MC2	3/8	1/8	13/16	1.46	.175
A6MC4-MG	PP6MC4	F6MC4	3/8	1/4	13/16	1.41	.250
A6MC6-MG	PP6MC6	F6MC6	3/8	3/8	13/16	1.27	.250
A6MC8-MG		F6MC8	3/8	1/2	15/16	1.45	.250
A8MC6-MG			1/2	3/8	15/16	1.65	.360
A8MC8-MG			1/2	1/2	15/16	1.46	.375

For nonstandard plastic collet, remove -MG suffix.

# EU - Elbow Union

## Tube-to-Tube

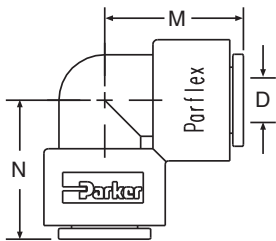

Gray Acetal Nitrile Seal	White Polypropylene EPDM Seal	Natural Kynar Viton Seal	Nom. Tube O.D.	M	N	D Thru Hole Min.
#	#	#				
A2.5EU2.5			5/32	0.66	0.66	.100
A4EU4-MG	PP4EU4	F4EU4	1/4	0.87	0.87	.175
A5EU4-MG			5/16-1/4	1.02	0.90	.175
A5EU5-MG			5/16	1.02	1.02	.188
A6EU4-MG	PP6EU4	F6EU4	3/8-1/4	1.02	0.90	.212
A6EU5-MG			3/8-5/16	1.02	1.02	.175
A6EU6-MG	PP6EU6	F6EU6	3/8	1.02	1.02	.250
A8EU6-MG			1/2-3/8	1.20	1.20	.250
A8EU8-MG			1/2	1.20	1.20	.375

For nonstandard plastic collet, remove -MG suffix.

All sizes in inches.



## TU - Tee Union Tube-to-Tube

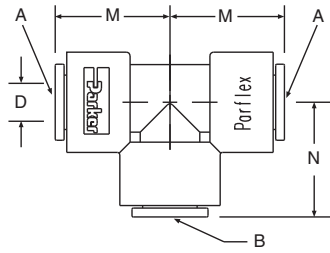

Gray Acetal Nitrile Seal	White Polypropylene EPDM Seal	Natural Kynar Viton Seal	Nom. Tube O.D.		M	N	D Thru Hole Min.
			Tube A Run	Tube B Stem			
#	#	#					
A2.5TU2.5			5/32	5/32	0.68	0.68	.100
A4TU4-MG	PP4TU4	F4TU4	1/4	1/4	0.81	0.85	.175
A5TU5-MG			5/16	5/16	1.02	1.02	.188
A6TU4-MG	PP6TU4	F6TU4	3/8	1/4	1.02	1.03	.175
A6TU6-MG	PP6TU6	F6TU6	3/8	3/8	1.02	1.02	.290
A8TU8-MG			1/2	1/2	1.20	1.20	.375

For nonstandard plastic collet, remove -MG suffix.

## WY - "Y" Union Tube-to-Tube

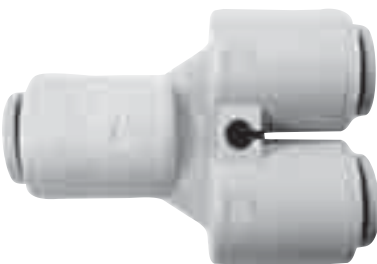
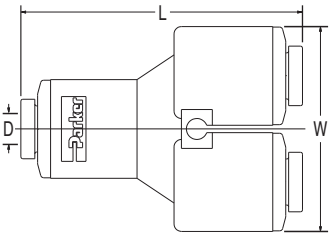

Gray Acetal Nitrile Seal	White Polypropylene EPDM Seal	Natural Kynar Viton Seal	Nom. Tube O.D.		L	W	D Thru Hole Min.
			Inlet Nom. Tube O.D.	Outlet Nom. Tube O.D.			
#	#	#					
A5WY5-MG			5/16	5/16	2.250	1.75	0.190
A6WY5-MG			3/8	5/16	2.200	1.75	0.190
A6WY6-MG			3/8	3/8	2.175	1.75	0.250

All sizes in inches.

# MES - Male Elbow Swivel

## Tube-to-Pipe

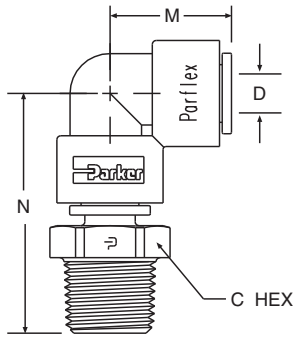

Gray Acetal Nitrile Seal	White Polypropylene EPDM Seal	Natural Kynar Viton Seal	Nom. Tube O.D.	NPTF Thread Size	C Hex	M	N	D Thru Hole Min.
#	#	#						
A4MES2-MG	PP4MES2	F4MES2	1/4	1/8	9/16	0.87	1.60	.175
A4MES4-MG	PP4MES4	F4MES4	1/4	1/4	11/16	0.87	1.71	.175
A4MES6-MG	PP4MES6	F4MES6	1/4	3/8	13/16	0.90	1.91	.212
A5MES2-MG			5/16	1/8	9/16	1.02	1.78	.188
A5MES4-MG			5/16	1/4	11/16	1.02	1.90	.188
A5MES6-MG			5/16	3/8	13/16	1.02	1.90	.188
A6MES2-MG		F6MES2	3/8	1/8	9/16	1.02	1.65	.175
A6MES4-MG	PP6MES4	F6MES4	3/8	1/4	13/16	1.02	1.90	.250
A6MES6-MG	PP6MES6	F6MES6	3/8	3/8	13/16	1.02	1.90	.250
A8MES4-MG			1/2	1/4	13/16	1.20	2.10	.240
A8MES6-MG			1/2	3/8	13/16	1.20	2.10	.375
A8MES8-MG			1/2	1/2	1	1.20	2.32	.375

\*Part consists of elbow union and tube stem adaptor.  
Note: Assemblies with metal gripper collets are permanent.  
Assemblies with plastic collets can be taken apart.

# MRS - Male Run Swivel

## Tube-to-Pipe

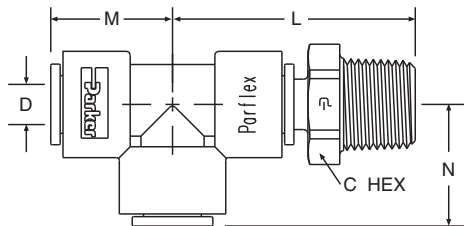

Gray Acetal Nitrile Seal	White Polypropylene EPDM Seal	Natural Kynar Viton Seal	Nom. Tube O.D.	NPTF Thread Size	C Hex	L	M	N	D Thru Hole Min.
#	#	#							
A4MRS2-MG	PP4MRS2	F4MRS2	1/4	1/8	9/16	1.55	0.81	0.85	.175
A4MRS4-MG	PP4MRS4	F4MRS4	1/4	1/4	11/16	1.67	0.81	0.85	.175
A5MRS2-MG			5/16	1/8	9/16	1.78	1.02	1.02	.188
A5MRS4-MG			5/16	1/4	11/16	1.90	1.02	1.02	.188
A5MRS6-MG			5/16	3/8	13/16	1.90	1.02	1.02	.188
A6MRS4-MG	PP6MRS4	F6MRS4	3/8	1/4	13/16	1.90	1.02	1.02	.250
A6MRS6-MG	PP6MRS6	F6MRS6	3/8	3/8	13/16	1.90	1.02	1.02	.250
A8MRS4-MG			1/2	1/4	13/16	2.10	1.20	1.20	.240
A8MRS6-MG			1/2	3/8	13/16	2.10	1.20	1.20	.375
A8MRS8-MG			1/2	1/2	1	2.32	1.20	1.20	.375

\*Part consists of tee union and tube stem adaptor.  
Note: Assemblies with metal gripper collets are permanent.  
Assemblies with plastic collets can be taken apart.

All sizes in inches.

E

# MTS - Male Tee Swivel Tube-to-Pipe

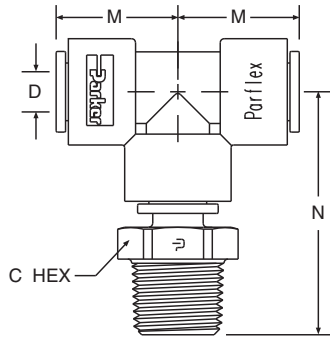

Gray Acetal Nitrile Seal	White Polypropylene EPDM Seal	Natural Kynar Viton Seal	Nom. Tube O.D.	NPTF Thread Size	C Hex	M	N	D Thru Hole Min.
#	#	#						
A4MTS2-MG	PP4MTS2	F4MTS2	1/4	1/8	9/16	0.81	1.60	.175
A4MTS4-MG	PP4MTS4	F4MTS4	1/4	1/4	11/16	0.81	1.71	.175
A5MTS2-MG			5/16	1/8	9/16	1.02	1.78	.188
A5MTS4-MG			5/16	1/4	11/16	1.02	1.90	.188
A5MTS6-MG			5/16	3/8	13/16	1.02	1.90	.188
A6MTS2-MG		F6MTS2	3/8	1/8	9/16	1.02	1.75	.175
A6MTS4-MG	PP6MTS4	F6MTS4	3/8	1/4	13/16	1.02	1.90	.250
A6MTS6-MG	PP6MTS6	F6MTS6	3/8	3/8	13/16	1.02	1.90	.250
A8MTS4-MG			1/2	1/4	13/16	1.20	2.10	.240
A8MTS6-MG			1/2	3/8	13/16	1.20	2.10	.375
A8MTS8-MG			1/2	1/2	1	1.20	2.32	.375

\*Part consists of tee union and tube stem adaptor.  
Note: Assemblies with metal gripper collets are permanent.  
Assemblies with plastic collets can be taken apart.

# UC - Union Connector Tube-to-Tube

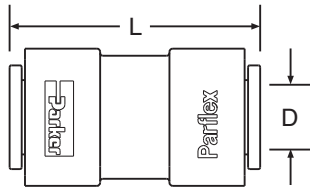

Gray Acetal Nitrile Seal	White Polypropylene EPDM Seal	Natural Kynar Viton Seal	Nom. Tube O.D.	L Overall Length	D Thru Hole Min.
#	#	#			
A2.5UC2.5			5/32	1.16	.100
A4UC4-MG	PP4UC4	F4UC4	1/4	1.49	.175
A5UC4-MG			5/16-1/4	1.70	.175
A5UC5-MG			5/16	1.70	.188
A6UC4-MG	PP6UC4	F6UC4	3/8-1/4	1.70	.175
A6UC5-MG			3/8-5/16	1.70	.188
A6UC6-MG	PP6UC6	F6UC6	3/8	1.70	.250
A8UC5-MG			1/2-5/16	1.90	.188
A8UC6-MG			1/2-3/8	1.90	.250
A8UC8-MG			1/2	1.91	.375

For nonstandard plastic collet, remove -MG suffix.

All sizes in inches.

## CU - Cross Union Tube-to-Tube

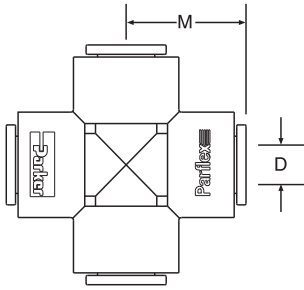

Gray Acetal Nitrile Seal	White Polypropylene EPDM Seal	Natural Kynar Viton Seal	Nom. Tube O.D.	M	D Thru Hole Min.
#	#	#			
A4CU4-MG			1/4	.91	.175
A6CU6-MG			3/8	1.08	.250

For nonstandard plastic collet, remove -MG suffix.

**E**

## FA - Faucet Adapter Tube-to-Faucet

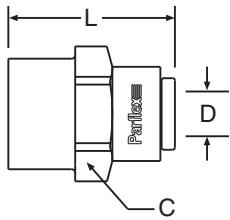

Gray Acetal Nitrile Seal	White Polypropylene EPDM Seal	Natural Kynar Viton Seal	Nom. Tube O.D.	UNS-2B Thread Size	C Hex	L Overall Length	D Thru Hole Min.
#	#	#					
A4FA7-MG	PP4FA7	F4FA7	1/4	7/16-24	23/32	1.32	.190
A5FA7-MG			5/16	7/16-24	13/16	1.41	.190
A6FA7-MG	PP6FA7	F6FA7	3/8	7/16-24	13/16	1.41	.190

For nonstandard plastic collet, remove -MG suffix.

All sizes in inches.

## TMC - Tube Stem Adapter

### Tube Stem-to-Pipe

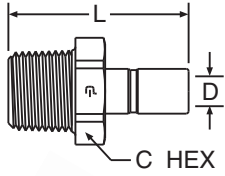

Gray Acetal	White Polypropylene	Natural Kynar	Tube Stem O.D.	NPTF Thread Size	C Hex	L Overall Length	D Thru Hole Min.
#	#	#					
A2.5TMC2			5/32	1/8	0.55	1.05	.100
A2.5TMC4			5/32	1/4	0.55	1.25	.100
A4TMC2	PP4TMC2	F4TMC2	1/4	1/8	9/16	1.44	.175
A4TMC4	PP4TMC4	F4TMC4	1/4	1/4	11/16	1.56	.175
A5TMC2			5/16	1/8	9/16	1.55	.188
A5TMC4			5/16	1/4	11/16	1.67	.188
A5TMC6			5/16	3/8	13/16	1.67	.188
A6TMC4	PP6TMC4	F6TMC4	3/8	1/4	13/16	1.70	.250
A6TMC6	PP6TMC6	F6TMC6	3/8	3/8	13/16	1.70	.250
A8TMC4			1/2	1/4	13/16	1.82	.240
A8TMC6			1/2	3/8	13/16	1.82	.375
A8TMC8			1/2	1/2	1	2.04	.375

## BU - Bulkhead Union

### Tube-to-Tube

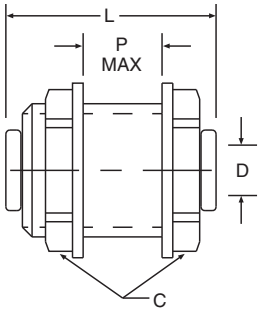

Gray Acetal Nitrile Seal	White Polypropylene EPDM Seal	Natural Kynar Viton Seal	Nom. Tube O.D.	C1 Hex	C2 Hex	L Overall Length	P Max. Wall Thk.	D Thru Hole Min.	Bulkhead Hole Drill Size
#	#	#							
A2.5BU2.5			5/32	9/16	3/4	1.29	.62	.100	5/8
A4BU4-MG	PP4BU4	F4BU4	1/4	15/16	15/16	1.50	.50	.175	7/8
A5BU5-MG			5/16	1-1/16	1-1/16	1.75	.62	.188	1
A6BU4-MG	PP6BU4		3/8-1/4	1-1/16	1-1/16	1.75	.62	.175	1
A6BU6-MG	PP6BU6	F6BU6	3/8	1-1/16	1-1/16	1.75	.62	.250	1
A8BU8-MG			1/2	1-1/4	1-1/4	2.04	.70	.375	1-1/8

For nonstandard plastic collet, remove -MG suffix.

All sizes in inches.





## TEU - Tube Elbow Union Tube-to-Tube Stem

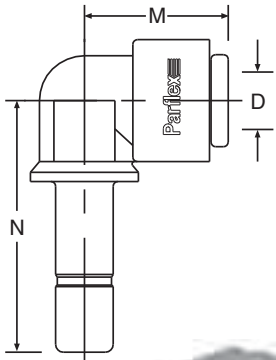

Gray Acetal Nitrile Seal	White Polypropylene EPDM Seal	Natural Kynar Viton Seal	Nom. Tube O.D.	Tube Stem O.D.	M	N	D Thru Hole Min.
#	#	#					
A2.5TEU2.5			5/32	5/32	.62	.85	.100
A4TEU4-MG	PP4TEU4	F4TEU4	1/4	1/4	.84	1.21	.125
A4TEU6-MG		F4TEU6	1/4	3/8	.84	1.35	.125
A5TEU5-MG			5/16	5/16	1.03	1.40	.188
A6TEU4-MG		F6TEU4	3/8	1/4	1.03	1.29	.125
A6TEU6-MG	PP6TEU6	F6TEU6	3/8	3/8	1.03	1.64	.250

For nonstandard plastic collet, remove -MG suffix.

## RD - Tube Reducer Tube-to-Tube Stem

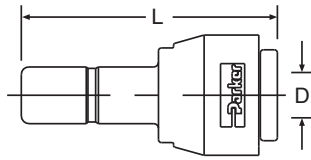

Gray Acetal Nitrile Seal	White Polypropylene EPDM Seal	Natural Kynar Viton Seal	Nom. Tube O.D.	Stem O.D.	L	D Thru Hole Min.
#	#	#				
A4RD5-MG	PP4RD5		1/4	5/16	1.62	.18
A4RD6-MG	PP4RD6		1/4	3/8	1.65	.18
A5RD6-MG			5/16	3/8	1.78	.25
A5RD8-MG			5/16	1/2	1.90	.25
A6RD8-MG			3/8	1/2	1.90	.25

For nonstandard plastic collet, remove -MG suffix.

## CAP - Tube Cap

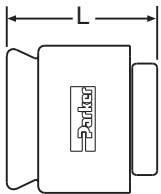

Gray Acetal Nitrile Seal	White Polypropylene EPDM Seal	Natural Kynar Viton Seal	Nom. Tube O.D.	L Overall Length
#	#	#		
A4CAP-MG	PP4CAP	F4CAP	1/4	0.77
A6CAP-MG	PP6CAP		3/8	.88

For nonstandard plastic collet, remove -MG suffix.

All sizes in inches.

## FE - Female Elbow

### Tube-to-Tube

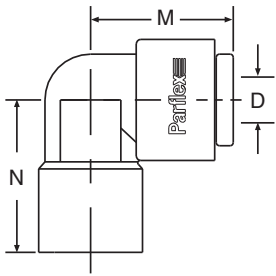

Gray Acetal Nitrile Seal	White Polypropylene EPDM Seal	Natural Kynar Viton Seal	Nom. Tube O. D.	NPTF Thread Size	M	N	D Thru Hole Min.
#	#	#					
A4FE4-MG			1/4	1/4	.84	1.00	.18
A6FE4-MG			3/8	1/4	1.03	1.00	.25
A6FE6-MG			3/8	3/8	1.03	1.00	.25

For nonstandard plastic collet, remove -MG suffix.

**E**

## ME - Male Elbow

### Tube-to-Pipe

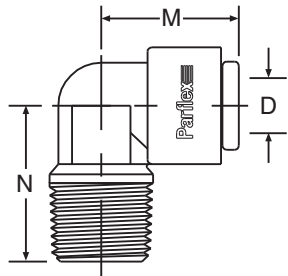

Gray Acetal Nitrile Seal	White Polypropylene EPDM Seal	Natural Kynar Viton Seal	Nom. Tube O.D.	NPTF Thread Size	M	N	D Thru Hole Min.
#	#	#					
A4ME2-MG	PP4ME2	F4ME2	1/4	1/8	0.84	0.94	.175
A4ME4-MG	PP4ME4	F4ME4	1/4	1/4	0.84	0.94	.175
A4ME6-MG	PP4ME6	F4ME6	1/4	3/8	0.84	1.04	.175
A5ME4-MG			5/16	1/4	1.03	1.08	.175
A5ME6-MG			5/16	3/8	1.03	1.06	.188
A6ME4-MG	PP6ME4	F6ME4	3/8	1/4	1.03	1.08	.250
A6ME6-MG	PP6ME6	F6ME6	3/8	3/8	1.03	1.06	.250

For nonstandard plastic collet, remove -MG suffix.

## ST - Straight Thread

### Tube-to-Male O-Ring Boss

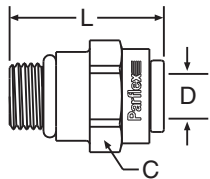

Gray Acetal Nitrile Seal	White Polypropylene EPDM Seal	Natural Kynar Viton Seal	Nom. Tube O.D.	UNF-2A Thread Size	C Hex	L Overall Length	D Thru Hole Min.
#	#	#					
A6ST9-MG		F6ST9	3/8	9/16-18	13/16	1.39	.250

For nonstandard plastic collet, remove -MG suffix.

All sizes in inches.

## TCB - Tube-to-Barb Connector

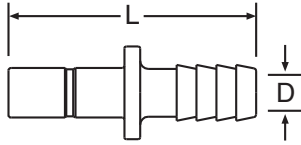

Gray Acetal	White Polypropylene	Natural Kynar	Tube Stem O.D.	Tube I.D.	L Overall Length	D Thru Hole Min.
#	#	#				
A4TCB4	PP4TCB4	F4TCB4	1/4	1/4	1.67	.140
A6TCB4		F6TCB4	3/8	1/4	1.82	.140
A6TCB6	PP6TCB6	F6TCB6	3/8	3/8	1.98	.250
A8TCB6			1/2	3/8	2.10	.250
A8TCB8			1/2	1/2	2.10	.375

## TEB - Tube Elbow Barb Connector

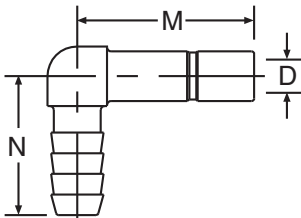

Gray Acetal	White Polypropylene	Natural Kynar	Tube Stem O.D.	Tube I.D.	M	N	D Thru Hole Min.
#	#	#					
A4TEB4	PP4TEB4	F4TEB4	1/4	1/4	0.89	1.00	.140
A6TEB6	PP6TEB6	F6TEB6	3/8	3/8	1.34	1.21	.250
A8TEB8			1/2	1/2	1.30	1.30	.390

## TPL - Plug

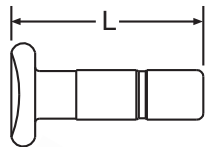

Gray Acetal	White Polypropylene	Natural Kynar	Fitting Size	L Overall Length
#	#	#		
A2.5TPL			5/32	0.63
A4TPL	PP4TPL	F4TPL	1/4	0.88
A6TPL	PP6TPL	F6TPL	3/8	1.45
A8TPL			1/2	1.50

All sizes in inches.

# TSC - Cartridge Insert



Part Number with Nitrile Seal	Nom. Tube O.D.	A* Diameter ±.002	B Diameter ±.002	C Diameter ±.002	D Diameter ±.002	E Depth ±.002	F Depth ±.002	G Depth ±.002	H* Centerline of Ports ±.002
#									
ATSC4-MG	1/4	.528	.421	.260	.175	.230	.435	.600	.670
ATSC6-MG	3/8	.632	.545	.385	.250	.280	.455	.705	.790
ATSC8-MG	1/2	.774	.668	.510	.375	.315	.510	.810	1.250

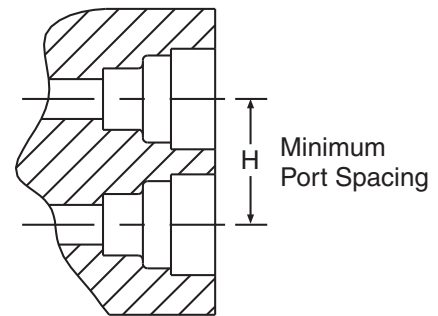
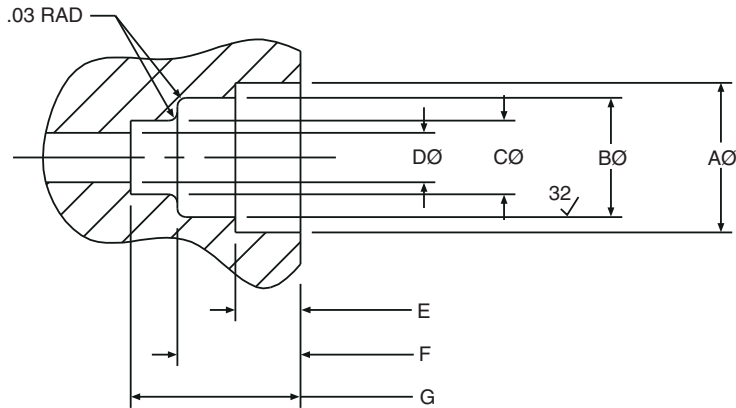

**Parker TrueSeal™ Cartridge Inserts:**

Allow you to machine or mold a tube connection into your equipment or components. By using cartridge inserts, you will reduce your material and assembly costs, reduce potential leak paths, and give your equipment a new, clean profile by eliminating the need for threaded connections. Part number ATSC4 consists of 1 o-ring, 1 cartridge, and 1 collet.

\*Cartridge inserts are rated at 300 psi. Test results are measured using Noryl® as the receiving material. Other materials may produce different results. Consult the Parflex Division for required dimensions when using filled and unfilled polypropylene, Abs, and nylon.

**Assembly Instructions:**

- Step 1**—Machine or mold the receiving orifice as per the above dimensions.
- Step 2**—Place the cartridge insert squarely onto the prepared port opening making sure that the barbs of the cartridge are going into the hole and the lettering on the face of the cartridge is visible.
- Step 3**—Using a rubber mallet or press, insert the cartridge into the first gland orifice until its face is flush with the top surface of the port.
- Step 4**—Insert the o-ring into the cartridge and seat it evenly into the second gland orifice.
- Step 5**—Insert the collet into the cartridge opening.
- Step 6**—Insert tubing.

NORYL® is a registered trademark of the General Electric Co.

All sizes in inches.

# Polypropylene Ball Valves

For proven leak-free performance, specify **Parflex® Polypropylene Ball Valves**. Their corrosion-resistant, all-plastic design makes them ideal for water filtration units, coffee and beverage machines and a wide variety of other fluid applications. Polypropylene material meets all FDA and NSF-51 requirements for food contact.

**Features/Benefits:**

- Precision molded, all-plastic design is leak free and corrosion resistant.
- Polypropylene material offers a wider chemical acceptance range, as well as a wide temperature range.
- Bi-directional flow maximizes productivity.
- Full flow design reduces pressure drop across the valve.
- Special o-ring seal ensures a reliable leak-tight connection.
- TrueSeal™ connection reduces potential leaks.

**Specifications:**

- Temperature range: 0°F to 225°F (-18°C to 107°C).
- O-ring seal material: Nitrile.
- NSF-51 listed.
- Pressure rated to 150 psi with a 600 psi burst pressure.

**Advantages:**

- Reduce costs—Built-in TrueSeal™ connection eliminates the need for a secondary fitting.
- Save space—Low-profile design allows for easy assembly and access where space is at a premium.

**Assembly Instructions:**

1. Inspect the mating threads for debris or damage. Remove any old fluoropolymer tape or sealant on previously used threads. If threads are damaged, replace with new adapter before proceeding.
2. Apply 2 to 3 wraps of fluoropolymer tape, Parker TrueSealant™ or an NSF/FDA approved silicon sealant. Do not use Plumbers Putty or Pipe Dope. These chemically react with plastic materials and could cause a failure.
3. Align ball valve to mating thread to ensure cross threading does not occur.
4. Screw ball valve onto mating thread 3 to 5 turns. This should be sufficient to properly seal the threads.
5. Pressurize system and check for leaks.

## VME - Valve Male Elbow

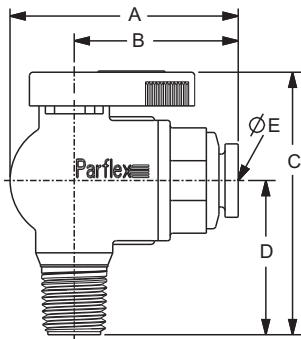

Part No.	Nom. Tube O.D.	NPTF Thread Size	A	B	C	D	øE Min. Thru Hole
#							
PP4VME2-MG	1/4	1/8	1.74	1.21	2.00	1.10	.19
PP4VME4-MG	1/4	1/4	1.74	1.21	2.18	1.28	.19
PP4VME6-MG	1/4	3/8	1.74	1.21	2.18	1.28	.19
PP4VME8-MG	1/4	1/2	1.74	1.21	2.37	1.47	.19
PP6VME2-MG	3/8	1/8	1.85	1.32	2.00	1.10	.25
PP6VME4-MG	3/8	1/4	1.85	1.32	2.18	1.28	.25
PP6VME6-MG	3/8	3/8	1.85	1.32	2.18	1.28	.25
PP6VME8-MG	3/8	1/2	1.85	1.32	2.37	1.47	.25

### VFE - Valve Female Elbow

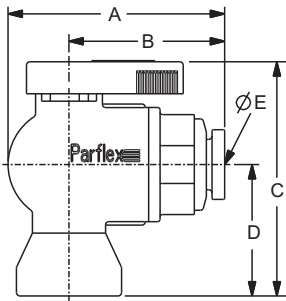

Part No.	Nom. Tube O.D.	NPTF Thread Size	A	B	C	D	øE Min. Thru Hole
#							
PP4VFE2-MG	1/4	1/8	1.74	1.21	1.82	0.92	.19
PP4VFE4-MG	1/4	1/4	1.74	1.21	2.05	1.15	.19
PP4VFE6-MG	1/4	3/8	1.74	1.21	2.18	1.28	.19
PP6VFE2-MG	3/8	1/8	1.85	1.32	1.82	0.92	.25
PP6VFE4-MG	3/8	1/4	1.85	1.32	2.05	1.15	.25
PP6VFE6-MG	3/8	3/8	1.85	1.32	2.18	1.28	.25



### VUC - Valve Union Connector

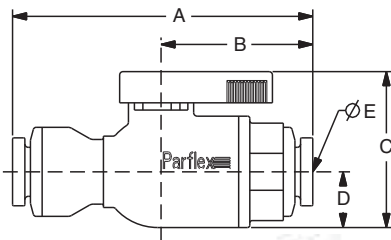

Part No.	Tube Size	Tube Size	A	B	C	D	øE Min. Thru Hole
#							
PP4VUC4-MG	1/4	1/4	2.51	1.21	1.4	0.5	.19
PP4VUC6-MG	1/4	3/8	2.62	1.21	1.4	0.5	.19
PP6VUC4-MG	3/8	1/4	2.56	1.32	1.4	0.5	.19
PP6VUC6-MG	3/8	3/8	2.67	1.32	1.4	0.5	.25

## VEU - Valve Elbow Union

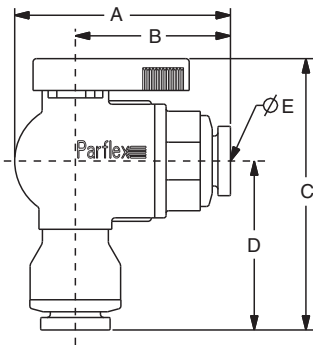

Part No.	Tube Size	Tube Size	A	B	C	D	øE Min. Thru Hole
#							
PP4VEU4-MG	1/4	1/4	1.74	1.21	2.29	1.39	.19
PP4VEU6-MG	1/4	3/8	1.74	1.21	2.34	1.44	.11
PP6VEU4-MG	3/8	1/4	1.85	1.32	2.29	1.39	.19
PP6VEU6-MG	3/8	3/8	1.85	1.32	2.34	1.44	.25



## VMC - Valve Male Connector

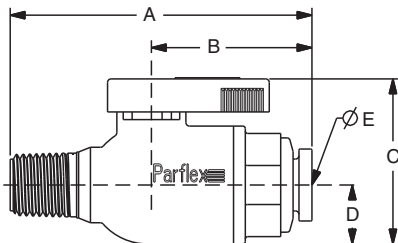

Part No.	Tube Size	NPTF Thread Size	A	B	C	D	øE Min. Thru Hole
#							
PP4VMC2-MG	1/4	1/8	2.22	1.21	1.4	0.5	.19
PP4VMC4-MG	1/4	1/4	2.40	1.21	1.4	0.5	.19
PP4VMC6-MG	1/4	3/8	2.40	1.21	1.4	0.5	.19
PP4VMC8-MG	1/4	1/2	2.59	1.21	1.4	0.5	.19
PP6VMC2-MG	3/8	1/8	2.33	1.32	1.4	0.5	.25
PP6VMC4-MG	3/8	1/4	2.51	1.32	1.4	0.5	.25
PP6VMC6-MG	3/8	3/8	2.51	1.32	1.4	0.5	.25
PP6VMC8-MG	3/8	1/2	2.70	1.32	1.4	0.5	.25



## VFC - Valve Female Connector

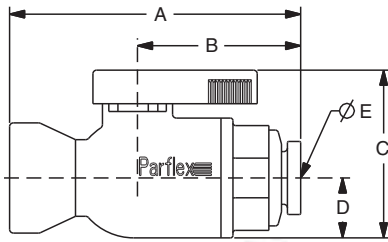

Part No.	Tube Size	NPTF Thread Size	A	B	C	D	øE Min. Thru Hole
#							
PP4VFC2-MG	1/4	1/8	2.04	1.21	1.4	0.5	.19
PP4VFC4-MG	1/4	1/4	2.27	1.21	1.4	0.5	.19
PP4VFC6-MG	1/4	3/8	2.40	1.21	1.4	0.5	.19
PP6VFC2-MG	3/8	1/8	2.15	1.32	1.4	0.5	.25
PP6VFC4-MG	3/8	1/4	2.38	1.32	1.4	0.5	.25
PP6VFC6-MG	3/8	3/8	2.51	1.32	1.4	0.5	.25

E

## SC - Safety Clip (Patent No. 6,065,779)



Standard color is black or blue.  
Other colors available upon request.

Part Number	Part Number	For Nominal Tube O.D.
#	#	
SC-4	SC-4-B	1/4
SC-5	SC-5-B	5/16
SC-6	SC-6-B	3/8
SC-8	SC-8-B	1/2

## TS - Tube Supports



To be used with soft durometer tubing.

Nylon Part Number	Polypropylene Part Number
#	#
N4TS3	P4TS3
N5TS3	P5TS3
N6TS4	P6TS4
N8TS6	P8TS6

## PTS - Pipe Thread Sealant



NSF-51 listed silicone.

## AQRT - Quick Release Tool

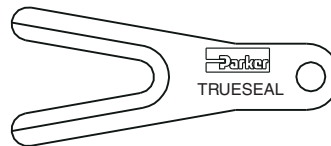

Makes disconnection of tube adapters and tubing a breeze.



## PTC - Plastic Tube Cutter PTC-001-RB

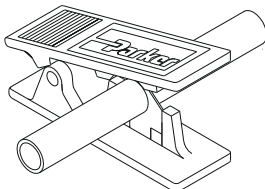

Plastic tube cutter and replacement blades.