

## SN & WS

3/4" Wide (SN)  
2-1/2" Wide (WS)



### Type SN

- 9-1/2 - 35-3/4" Lengths
- 100 - 600 Watts
- 120 and 240 Volt
- 7 - 11 W/In<sup>2</sup>

### Type WS

- 6-1/2 - 25-1/2" Lengths
- 400 - 1,500 Watts
- 120 and 240 Volt
- 8 - 25 W/In<sup>2</sup>

### Dimensions (type SN)

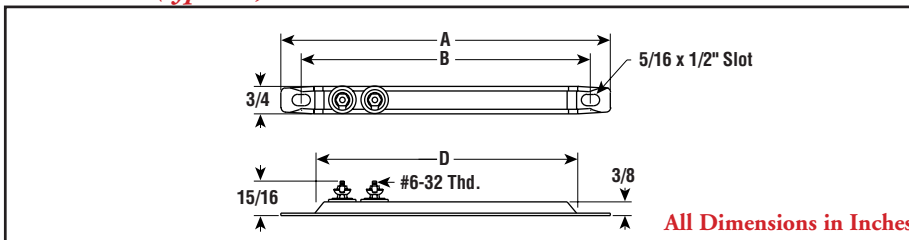

### Specifications and Ordering Information

Dimensions (In.)			Watts	W/In <sup>2</sup>	Model	Rust-Resisting Iron Sheath				Wt. (Lbs.)	
A	B	D				120V		240V			
						Stock	PCN	Stock	PCN		
9-1/2	8-1/2	8	100	8	SN-910	S	132919	—	—	0.4	
10-1/2	9-1/2	9	150	11	SN-1015	S	132927	—	—	0.5	
12	11	10-1/2	150	9	SN-1215	S	132935	—	—	0.6	
15-1/4	14-1/4	13-3/4	200	8	SN-1520	S	132943	S	132951	0.8	
17-7/8	16-7/8	16-3/8	250	8	SN-1825	S	132960	S	132978	0.9	
23-3/4	22-3/4	22-1/4	300	7	SN-2430	S	132986	S	132994	1	
30-3/8	29-3/8	28-7/8	450	8	SN-3045	S	133006	S	133014	1.3	
35-3/4	34-3/4	34-1/4	600	9	SN-3660	NS	133022	S	133030	1.5	

**Stock Status:** S = stock AS = assembly stock NS = non-stock  
**To Order**—Specify model, PCN, watts, volts and quantity.

### Applications

Strip heaters are used for heat transfer by conduction or convection to heat liquids, air, gases and surfaces. See guidelines in the Strip Heater Overview section.

### Dimensions (type WS)

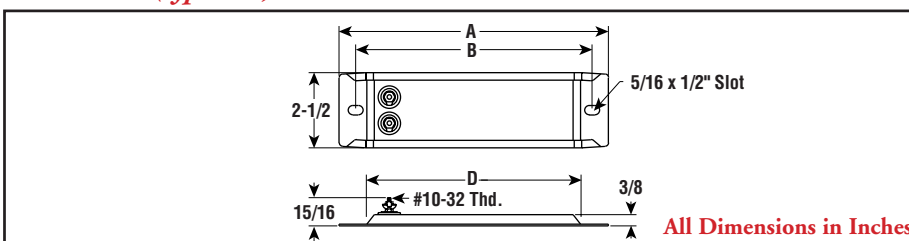

### Specifications and Ordering Information

Dimensions (In.)			Watts	W/In <sup>2</sup>	Model	120V		240V		Wt. (Lbs.)
A	B	D				Stock	PCN	Stock	PCN	
<b>WS — Rust-Resisting Iron Sheath</b>										
6-1/2	5-1/2	5	400	14	WS-640	S	132716	S	132724	0.8
8-1/2	7-1/2	7	500	16	WS-850	S	132732	S	132740	1
12	11	10-1/2	600	12	WS-1260	NS	144880	NS	144899	1.4
15-1/4	14-1/4	13-3/4	750	11	WS-1575	S	132759	S	132767	1.9
21	20	19-1/2	850	8	WS-2185	NS	132775	NS	132783	2.3
25-1/2	24-1/2	24	1,000	8	WS-2510	S	132791	S	132804	2.6
<b>WS — Chrome Steel Sheath</b>										
6-1/2	5-1/2	5	500	25	WS-605	S	132812	S	132820	0.8
8-1/2	7-1/2	7	600	19	WS-806	S	132839	S	132847	1
12	11	10-1/2	800	16	WS-1208	NS	144872	NS	144864	1.4
15-1/4	14-1/4	13-3/4	1,000	14	WS-1501	S	132855	S	132863	1.9
21	20	19-1/2	1,250	12	WS-2101	NS	132871	S	132880	2.3
25-1/2	24-1/2	24	1,500	12	WS-2515	NS	132898	S	132900	2.6

**Stock Status:** S = stock AS = assembly stock NS = non-stock  
**To Order**—Specify model, PCN, watts, volts and quantity.

**Note** — If terminal housing is required with a type WS strip heater, use a type SE-AC-1 mounted sideways. Ceramic post terminal insulators can also be used. (See Strip Heater Overview Section.)