

Features

- Compact Spool Valve convertible from 3/2 to 5/2 with flow plates
- Mount directly to actuators with NAMUR interface per VDI/VDE 3845
- Single and dual solenoid constructions available
- Integral Breather Block vents to spring side of actuator to exhaust, preventing corrosion of the actuator
- Unique design combines hard T-seals and flexible o-rings, provides bubble-tight shutoff, resistance to dirt and multimillion cycle life controlling air or inert gas

Construction

Valve Parts in Contact with Fluids ①		
Body	Brass	316L Stainless Steel
End Cover (Spring end)	Brass	316L Stainless Steel
Spool Valve Internals	Brass, POM	
Pilot End Covers	Brass	316L Stainless Steel
Core Tube	Stainless Steel	
Core and Plugnut	Stainless Steel	
Springs	Stainless Steel	
Seals and Discs	NBR	
Top Disc	PA	
Core Guide	POM	
Seat and Seat Insert	Brass, POM	
Shading Coil	Copper	
Rider Ring (low power)	PTFE	

① Consult factory for construction details on catalogue numbers EE8551P401 and EE8551P409.

Electrical

Standard Coil and Class of Insulation	① Watt Rating and Power Consumption				Spare Coil Part Number	
	DC Watts	AC			Explosionproof	
		Watts	VA Holding	VA Inrush	AC	DC
F	11.6	10.1	25	50	238614	238714

Standard Voltages: 24, 120, 240, 480 volts AC, 60 Hz (110, 220 volts AC, 50 Hz).
 6, 12, 24, 120, 240 volts DC. Must be specified when ordering.
 Other voltages are available when required.
 ① Consult factory for electrical information and standard voltages on catalogue numbers EE8551P401 and EE8551P409.

Solenoid Enclosures

RedHat II

Standard: Explosionproof and Watertight, Types 3, 3S, 4, 4X, 6, 6P, 7, and 9.
 For Optional Features, consult factory.

RedHat Next Generation

Standard: Class I, Division 2 for Hazardous Locations/Watertight. Meets Types 1 through 4X and UL listed and CSA certified for Class I, Division 2, Groups A, B, C and D and Class II, Division 2, Groups F and G.

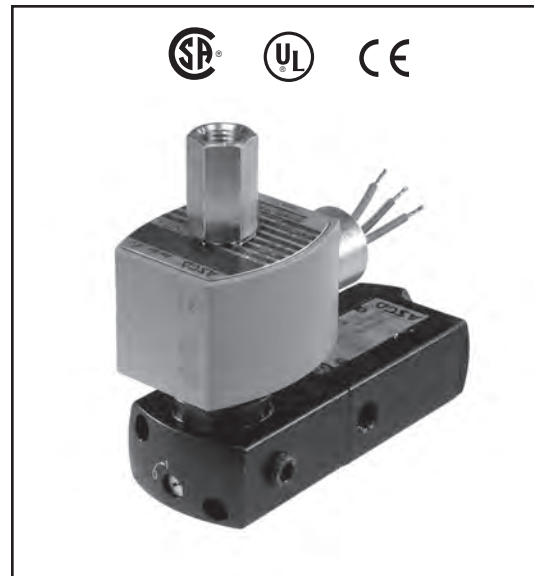

4-WAY

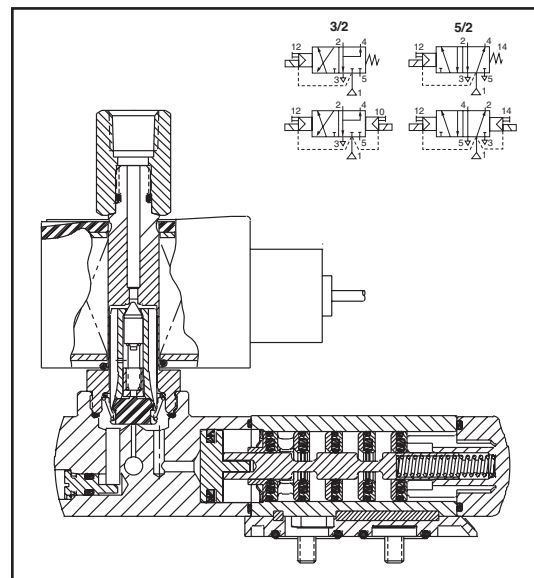

Nominal Ambient Temp. Ranges

RedHat II

AC: -40°F to 125°F (-40°C to 52°C)
 DC: -40°F to 104°F (-40°C to 40°C)

RedHat Next Generation

AC/DC: -40°F to 140°F (40°C to 60°C)

Approvals

CSA certified, UL listed solenoids.
 Meets applicable CE directives.

Specifications

Body Material	Pipe Size (ins.)	Orifice Size (ins.)	Cv Flow Factor	Single Solenoid							Dual Solenoid								
				Operating Pressure Differential (psi) Air-Inert Gas			Max. Fluid Temp. °F		Catalogue Number	Const. Ref.	Operating Pressure Differential (psi) Air-Inert Gas			Max. Fluid Temp. °F		Catalogue Number	Const. Ref.	Watt Rating/ Class of Coil Insulation	
				Min.	Max. AC	Max. DC	AC	DC			Min.	Max. AC	Max. DC	AC	DC			AC	DC
Brass 3/2, 5/2 ③	1/4	1/4	0.86	30	150	120	140	120	EF8551G403 ④	1	30	150	120	140	120	EF8551G404 ④	1	10.1/F	11.6/F
316L Stainless Steel 3/2, 5/2 ③	1/4	1/4	0.86	30	150	150	180	180	EE8551P409 ①	②	-	-	-	-	-	-	-	2/H	2/H
	1/4	1/4	0.86	30	150	120	140	120	EV8551G409 ⑤	2	30	150	120	140	120	EV8551G410 ⑤	2	10.1/F	11.6/F

① RedHat Next Generation Valve. ② Consult factory for dimensions. ③ 1/8 inch NPT exhaust.
 ④ Brass construction supplied with EF solenoid. ⑤ Stainless steel construction supplied standard with EV solenoid.

Dimensions inches (mm)

Series	8551
NPT	1/4
L1 ①	4.96 (126)
L2 ①	6.50 (165)
H2	4.38 (111)
H1	1.57 (40)
W	1.77 (45)

① Manual override option MH adds .250" (6.4), MS option adds .468" (11.9) to each solenoid endcap.

Optional Manual Operators ①		
Add Suffix		Description
MO		Push and turn to lock with flat head screwdriver slot
MI		Momentary push in with flat head screwdriver slot
MH		Momentary push in by hand
MS		Push and turn to lock by hand

① For construction references 1 and 2 only

Const. Ref. 1

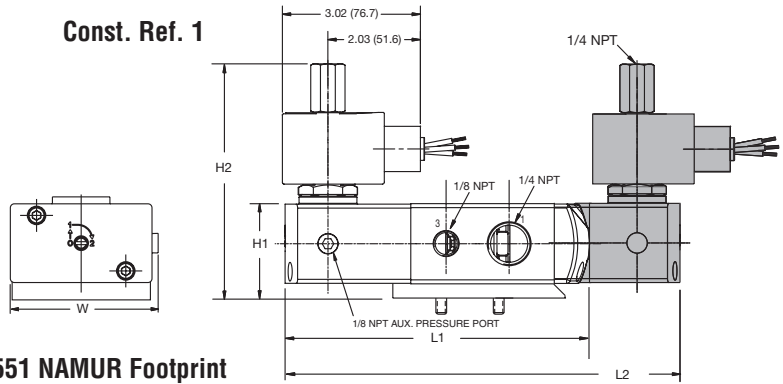

8551 NAMUR Footprint

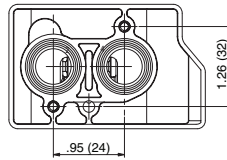

Series	8551 (5/3)
NPT	1/4
L1 ①	-
L2 ①	7.44 (189)
H2	4.38 (111)
H1	1.57 (40)
W	1.77 (45)

① Manual override option MH adds .250" (6.4), MS option adds .468" (11.9) to each solenoid endcap.

8551 NAMUR Footprint

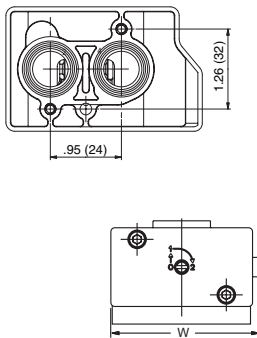

Const. Ref. 2

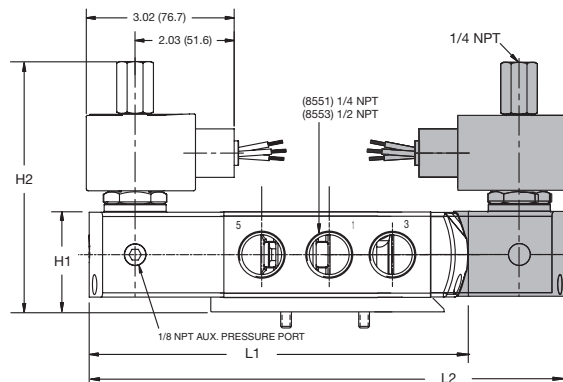

Optional Manual Operators		
Add Suffix		Description
MO		Push and turn to lock with flat head screwdriver slot
MI		Momentary push in with flat head screwdriver slot
MH		Momentary push in by hand
MS		Push and turn to lock by hand