

Miniature Surface Mount With Armored Cable

2200 Series

Applications

- Miniature, low-profile design
- Stainless steel armored cable for added reliability
- Wide working gap for overhead doors
- Small size less likely to be damaged by forklifts
- Aluminum bar stock resists corrosion in harsh environments
- Mounting hardware included
- Jacketed lead available

General Specifications

Enclosure	Aluminum (L)
Temperature Range	-40°F to 150°F (-40°C to 65°C)
Environmental	Hermetically Sealed Reed Switch Encapsulated in Polyurethane
NEMA Rating	1, 2, 3, 4, 4x, 5, 6, 12
Protection Class	IP 67
Response Time	1 msec max.
Life Cycles	100,000 Under Full Load, 10,000,000 Under Dry Circuit
Lead Types/O.D.	Stainless Steel Armored Cable with #22 Wire / 0.28"(0.71cm)
UL/ULC Listed	All Models

0.47" c. bore, 0.18" thru
1.19cm c. bore, 0.46cm thru

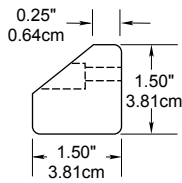
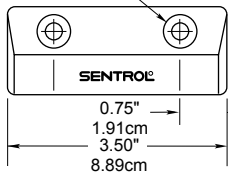

Magnet
Part No. 1958
(included)

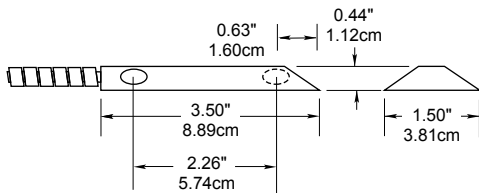

Magnet
Part No. 1982



Order Information

Electrical Specifications

Part Number	Contact ¹ Configuration	Load Rating (AC/DC)	Switching Voltage (AC/DC)	Switching Current (AC/DC)	Contact Resistance	Sense Range ² Minimum	Lead Length
2202A/2202AU-L	N.O.	7.5W/VA	100V	0.5A	0.2 Ohms	3.0" (7.6cm)	1.5'
2204A/2204AU-L	SPDT	3W/VA	30V	0.25A	0.2 Ohms	3.0" (7.6cm)	1.5'
2205AU-L	N.O.	7.5W/VA	100V	0.5A	0.2 Ohms	3.0" (7.6cm)	3'
2207A/2207AU-L	SPDT	3W/VA	30V	0.25A	0.2 Ohms	3.0" (7.6cm)	3'
1982	Flange Mount Universal Actuator Only						

Warning— Each electrical rating is an individual maximum and cannot be exceeded!

¹ Configuration with actuator away from the switch

² Proximity of ferrous materials usually reduces sense range — typically by 50%. The shape and type of material cause a wide diversity of effects.

Testing is required to determine actual sense range for specific applications. As measured on a nonferrous surface.

Gap distances are nominal make distance ± 20%. Gap Specifications are for switch to make. Break distance is approximately 1.1 to 1.5 times make.