

Animatics Corporation
 3200 Patrick Henry Dr
 Santa Clara
 CA 95054, USA
Phone: (408) 748 8721
Fax: (408) 748 8725
 E-mail: service@animatics.com

NEMA Size 23

BACKLASH

ratios 3:1 to 10:1 - 12 arc-minutes
 ratios 16:1 to 100:1 - 16 arc-minutes

EFFICIENCY

ratios 3:1 to 10:1 = 90%
 ratios 16:1 to 100:1 = 85%

INPUT RPM RANGE 0 to 5000 rpm

PEAK TORQUE 15% above continuous rating

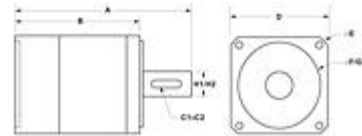

Results 1 - 8 of 8

Item #	List Price	Ratio	GI1 - Gear Inertia at input x 10 ⁻⁵	GI2 - Gear Inertia at input x 10 ⁻⁵	W1 - Weight	W2 - Weight
GH23SP004	QUOTE	4:1	4.19 lb-in-sec ²	0.47 kg-m ²	1.85 lbs	0.84 kg
GH23SP007	QUOTE	7:1	1.54 lb-in-sec ²	0.17 kg-m ²	1.85 lbs	0.84 kg
GH23SP010	QUOTE	10:1	1.08 lb-in-sec ²	0.12 kg-m ²	1.85 lbs	0.84 kg
GH23SP016	QUOTE	16:1	4.26 lb-in-sec ²	0.48 kg-m ²	2.9 lbs	1.32 kg
GH23SP028	QUOTE	28:1	1.57 lb-in-sec ²	0.18 kg-m ²	2.9 lbs	1.32 kg
GH23SP049	QUOTE	49:1	1.52 lb-in-sec ²	0.17 kg-m ²	2.9 lbs	1.32 kg
GH23SP070	QUOTE	70:1	1.06 lb-in-sec ²	0.12 kg-m ²	2.9 lbs	1.32 kg
GH23SP100	QUOTE	100:1	1.06 lb-in-sec ²	0.12 kg-m ²	2.9 lbs	1.32 kg

Results 1 - 8 of 8