

JB5 Jumper Bars

Terminal Blocks Accessories



RoHS
RoHS

5.2 mm 0.205 in spacing

Features and Benefits

Facilitate & secure your jumper bar assembly process:

- Screwless mounting,
- Pre-cut poles for various configurations,
- Insulated,
- Positive locking.

Ordering Details

Description	Color	Type	Order Code	Pack ^(ing) pieces	Weight (1 pce) g
5.2 mm 0.205 in spacing 2 poles	Orange	JB5-2	1SNK 905 302 R0000	50	1.30
3 poles		JB5-3	1SNK 905 303 R0000	50	2.00
4 poles		JB5-4	1SNK 905 304 R0000	50	2.70
5 poles		JB5-5	1SNK 905 305 R0000	50	3.50
10 poles		JB5-10	1SNK 905 310 R0000	30	7.10
50 poles		JB5-50	1SNK 905 350 R0000	10	36.10

Main Technical Data

	Tool	Torque	
Screwless			
Material Specifications	Insulating material	Polyamide	
	Flammability	V0	
	NF F 16 101	I2F3	
Ambient temperature min/max	Service IEC 60068-2-1	-55 +110 °C	
	Storage	-67 +230 F	
	Installing	-55 +110 °C	
		-67 +230 F	
		-5 +40 °C	
		-23 +104 F	
	IEC	cULus - CSA	Ex e
Rated current	32 A	30 A	
Rated voltage			
Standard use	1000 V	600 V	630 V
Cut extremities	800 V	300 V	Not authorized
Cut poles	400 V	300 V	Not authorized
Impulse withstand voltage	8000 V		
Protection	IP20	NEMA 1	

Accessories

Description	Color	Type	Order Code	Pack ^(ing) pieces	Weight (1 pce) g
Circuit Separators	Dark Grey	CS	1SNK 900 101 R0000	20	0.20

Some accessories may modify the terminal block's ratings. See complete information in "Technical Datasheet".

Mounting Instructions

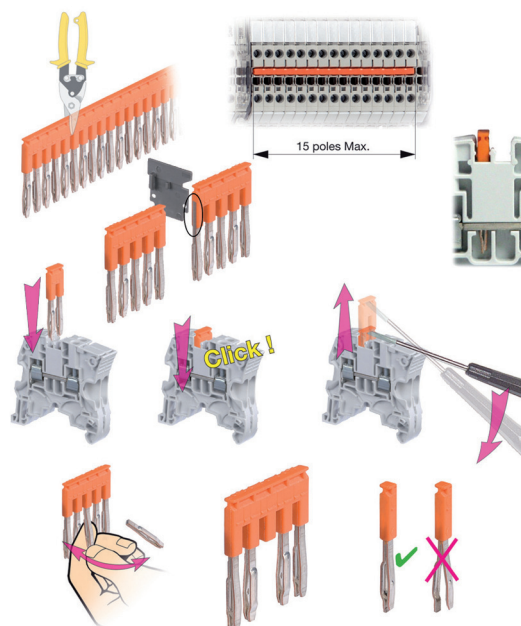

- Caution: the use of jumper bars with cut extremities is forbidden in Explosive atmospheres;

- For jumper bar with cut extremities, additional accessories must be installed on the cut side:

circuit separator CS when mounted on feed-through or ground terminal blocks,

circuit separator CS-R1 when mounted on disconnect terminal blocks,

end section ES4-D2 when mounted on double deck terminal blocks;

- Jumper bar with cut poles: for alternated jumpering between terminal blocks.

All the technical data for UL/CSA standard and dimensions in inches are in *italics*.